



# VAULT

**STRATEGIC MINING CORP.**

TSXV:KNOX | OTC:KNXFF | FSE:M850

## LEGAL DISCLAIMER

### FORWARD-LOOKING STATEMENTS

Certain statements and/or graphics in Vault Strategic Mining Corp. (the “Company”) press releases, web site and in corporate displays, among others, constitute “forward-looking statements”. These statements are based on information currently available to the Company and the Company provides no assurance that actual results will meet management’s expectations. Forward-looking statements include estimates and statements that describe the Company’s future plans, objectives or goals, including words to the effect that the Company or management expects a stated condition or result to occur. Forward looking statements may be identified by terms such as “believes”, “anticipates”, “expects”, “estimates”, “may”, “could”, “would”, “will”, or “plan”, or their conditional or future forms. Some forward-looking statements are based on assumptions and address future events and conditions, by their very nature they involve inherent risks and uncertainties. Actual results relating to, among other things, results of exploration, project development, reclamation and capital costs of the Company’s mineral properties, and the Company’s financial condition and prospects, could differ materially from those currently anticipated in such statements for many reasons such as: changes in general economic conditions and conditions in the financial markets; changes in demand and prices for minerals; litigation, legislative, environmental and other judicial, regulatory, political and competitive developments; technological and operational difficulties encountered in connection with the activities, and other matters discussed in this presentation. This list is not exhaustive of the factors that may affect any of the Company’s forward-looking statements. These and other factors should be considered carefully and readers should not place undue reliance on the Company’s forward-looking statements. The Company does not undertake to update any forward looking statement that may be made from time to time by the Company or on its behalf, except if required to do so by applicable securities laws. You are cautioned not to place any undue reliance on any forward-looking statement.

### FORWARD-LOOKING STATEMENTS OR INFORMATION RELATED TO EXPLORATION

Relating to exploration, the identification of exploration targets and any implied future investigation of such targets on the basis of specific geological, geochemical and geophysical evidence or trends are future-looking and subject to a variety of possible outcomes which may or may not include the discovery, extension, or termination of mineralization. Further, areas around known mineralized intersections or surface showings may be marked by wording such as “open”, “untested”, “possible extension” or “exploration potential” or by symbols such as “?”. Such wording or symbols should not be construed as a certainty that mineralization continues or that the character of mineralization (e.g. grade or thickness) will remain consistent from a known and measured data point. The key risk related to exploration in general are that chances of identifying economical reserves are extremely small. The presentation contains historical exploration data that have not been verified by Vault Strategic Mining Corp. and may not be accurate or complete, and therefore the information should not be relied upon.



**VAULT**  
**STRATEGIC MINING CORP.**

---

TSXV:KNOX | OTC:KNXFF | FSE:M850

**Vault** is a junior mining company focused on building leverage to gold, silver and strategic metals through disciplined option-based acquisition of advanced historical mining assets in the United States.

FUNDAMENTAL DATA (CAD)	
TSXV	KNOX
Current Outstanding	12,400,000
Warrants Outstanding	5,500,000
<b>Fully Diluted</b>	<b>17,900,000</b>

Vault Strategic Mining Corp. is a publicly listed company traded on the Toronto Stock Exchange (TSXV: KNOX), OTC (OTC: KNXFF), and Börse Frankfurt (FSE: M850),





Quinn Field-Dyte is a senior capital markets and mining executive with over two decades of experience in public company operations, mergers and acquisitions, corporate finance, and board governance within the natural resources sector. His career has been centered on supporting exploration and development stage mining companies through disciplined capital allocation, strategic growth initiatives, and effective engagement with public markets.

Mr. Field-Dyte has extensive experience navigating the full lifecycle of public mining companies, including corporate structuring, financings, asset acquisitions and divestitures, regulatory compliance, and shareholder communications. He has played a key role in evaluating mineral assets, advancing exploration strategies, and aligning corporate objectives with market conditions and long-term value creation.

At Vault Strategic Mining Corp., Mr. Field-Dyte contributes his deep expertise in corporate strategy, financial oversight, and governance. He is actively involved in guiding the Company's focus on historically advanced mining assets across North America, supporting disciplined exploration planning, capital markets strategy, and corporate development initiatives aligned with critical and strategic mineral opportunities.

Earlier in his career, Mr. Field-Dyte spent several years as an investment adviser, providing him with a strong foundation in financial analysis, risk management, and investor relations. This background continues to inform his practical, market-aware approach to decision-making at the board level.

Mr. Field-Dyte studied at Capilano University and Langara College. He is recognized for his strong understanding of public markets, his ability to execute complex transactions, and his commitment to building shareholder value through prudent management and strategic focus within the mining sector.

Quinn Field-Dyte  
CEO & Director

# MANAGEMENT



Yoshito Okubo  
Director

Mr. Okubo brings over a decade of experience in operations, business development, and emerging technologies, working across Canada, the U.S., Japan, and Southeast Asia. He has built his career at the intersection of traditional industries and transformative technologies, applying innovation to enhance efficiency, transparency, and scalability while navigating diverse regulatory environments and cross-border business dynamics.

His expertise lies in strengthening supply chain integrity and governance frameworks, particularly within the critical minerals ecosystem where traceability and responsible sourcing are essential. With a proven track record of scaling ventures through strategic partnerships, Mr. Okubo positions organizations to align technological innovation with real-world applications in energy, infrastructure, and advanced materials markets.



Daryn Gordon, CPA  
Director

Mr. Daryn Gordon is a Chartered Professional Accountant (CPA, CA) with more than two decades of finance and accounting experience. He started his career at global auditing firms Grant Thornton LLP and PwC Canada. For the last fourteen years, Mr. Gordon has continued to expand his expertise and knowledge by providing CFO services to Canadian companies across a variety of industries. Mr. Gordon has a Bachelor of Accounting degree from the University of Lethbridge.



Andreas Sleich  
Director

Mr. Schleich has over 20 years of international experience as a senior executive with both private and public companies. Over the course of his career, he has held several C-level management positions in multicultural and global environments in Germany, Denmark, Mexico and Canada. He holds a BBA in marketing and international business.

# INVESTMENT THESIS

	<ul style="list-style-type: none"><li>• <b>Strategic Asset Portfolio</b> Advanced historical U.S. mining assets with documented mineralization, offering immediate geological credibility and exploration upside.</li></ul>
	<ul style="list-style-type: none"><li>• <b>Risk-Managed Acquisition Model</b> Option-based acquisition strategy minimizes capital exposure while maximizing asset control—designed for disciplined growth with limited downside.</li></ul>
	<ul style="list-style-type: none"><li>• <b>Capital Structure Discipline</b> No equity dilution for acquisitions, preserving shareholder value and ensuring clean capital structure.</li></ul>
	<ul style="list-style-type: none"><li>• <b>Multi-Metal Exposure</b> Diversified leverage to precious metals (Gold, Silver) and strategic critical minerals (Tungsten, Beryllium), aligned with global demand trends and supply chain priorities.</li></ul>
	<ul style="list-style-type: none"><li>• <b>Clear Development Pathway</b> Defined roadmap from asset control to technical validation and re-rating, enabling value creation through staged de-risking and milestone-driven progress.</li></ul>

# » WHY THIS WORKS in 2026

- ◆ Precious Metal Prices at All-Time Highs
  - Gold traded above \$4,000/oz and Silver surpassed \$60/oz in 2025, setting new records that continue to influence 2026 valuations. [Precious Metals Outlook 2026](#)
  - Sustained central bank accumulation and geopolitical hedging are driving demand, especially for gold.
  - This price environment materially exceeds levels during historical development phases, making previously marginal assets economically viable.
  
- ◆ U.S. Policy Shift Toward Domestic Mining
  - The U.S. has intensified its focus on critical mineral independence, with policies favoring domestic exploration and permitting. [Mining & Metals 2026](#)
  - Resource nationalism and supply chain security are now central to industrial strategy, especially for strategic metals like Tungsten and Beryllium.
  - Federal and state incentives are increasingly aligned with reactivating legacy mining districts.
  
- ◆ Modern Techniques Unlock Historical Assets
  - Advances in exploration geophysics, remote sensing, and metallurgical recovery allow for efficient re-evaluation of historical sites.
  - Many legacy assets were underexplored due to technological limitations—now, low-cost validation programs can rapidly confirm mineralization and economic potential.

- ◆ Capital Markets Favor Disciplined Juniors
  - Investors are rewarding low-burn, asset-backed juniors over speculative plays [Mining and Metals Forecast 2026](#).
  - Option-based acquisition models with no equity dilution and clear technical milestones are seen as prudent and scalable.
  - The market is increasingly focused on real assets, clear development paths, and capital efficiency.

FACTOR	2026 Impact
Metal Prices	Supports re-rating of historical assets
U.S. Policy	Eases permitting and boosts investor confidence
Technology	Reduces exploration risk and cost
Capital Discipline	Enhances valuation and access to funding

# PORTFOLIO OVERVIEW - Five Historical Mining Projects

## 01 Wheeler Tungsten Project - Nevada, USA

- Historic production of 2,000 tons grading 1.3% WO<sub>3</sub> (1950s).
- Historic Feasibility Study to guide exploration with previous pilot scale production testing at Colorado School of Mines
- Major beryllium discovery delineated by Anaconda (1959–62) with 10,000 ft of drilling and 4,400 ft of underground development.
- Historical resource
- Untested potential for rare earth elements (REEs).
- 2026 Spring Exploration Planned

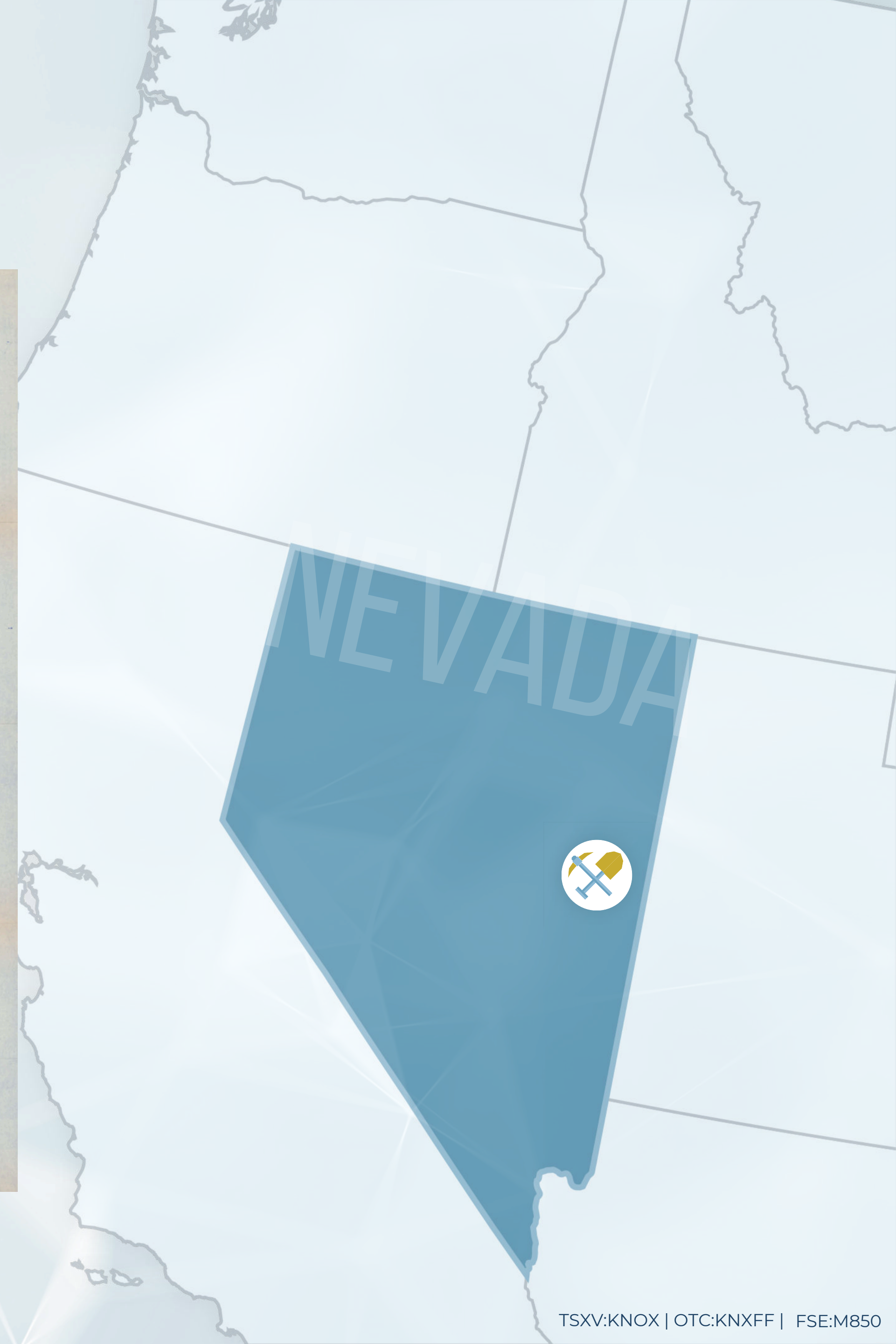
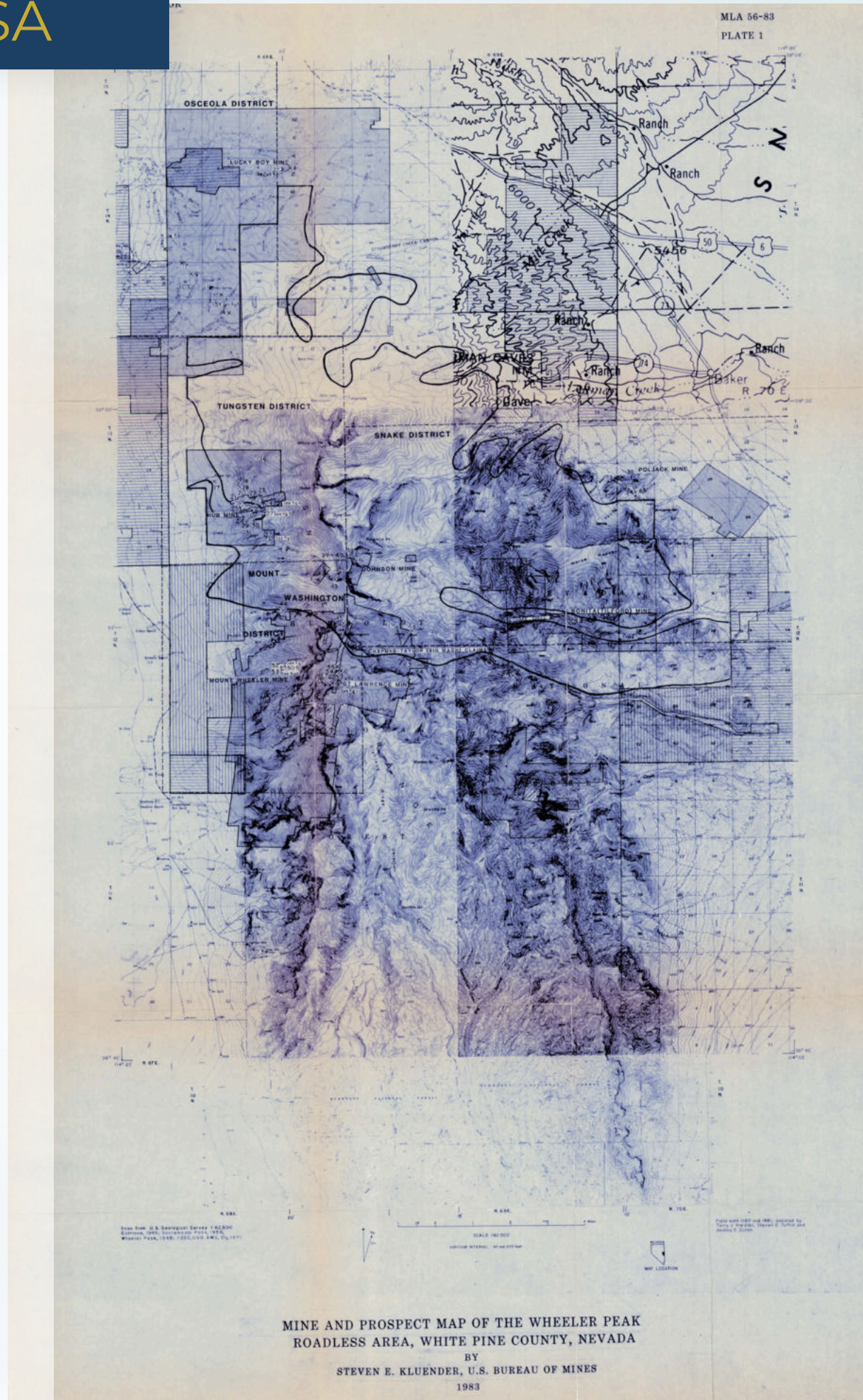

# PORTFOLIO OVERVIEW - Five Historical Mining Projects

## 02 Mia Silver Project - Idaho, USA

- Located in the historic Seafoam district, with silver and gold mineralization first discovered in the 1880s.
- Consolidated in the 1980s for systematic exploration by Northwest Minerals Development Corp.
- Historical assays include, up to 1.10 oz/ton gold and 178 oz/ton silver and multiple zones with high-grade silver including Betty Ruth, Canary Yellow, and Longshot.
- Sampling confirmed by U.S. Bureau of Mines and consulting geologist Michael R. Free.
- Offers multiple anomalous targets and strong exploration potential based on historical data.

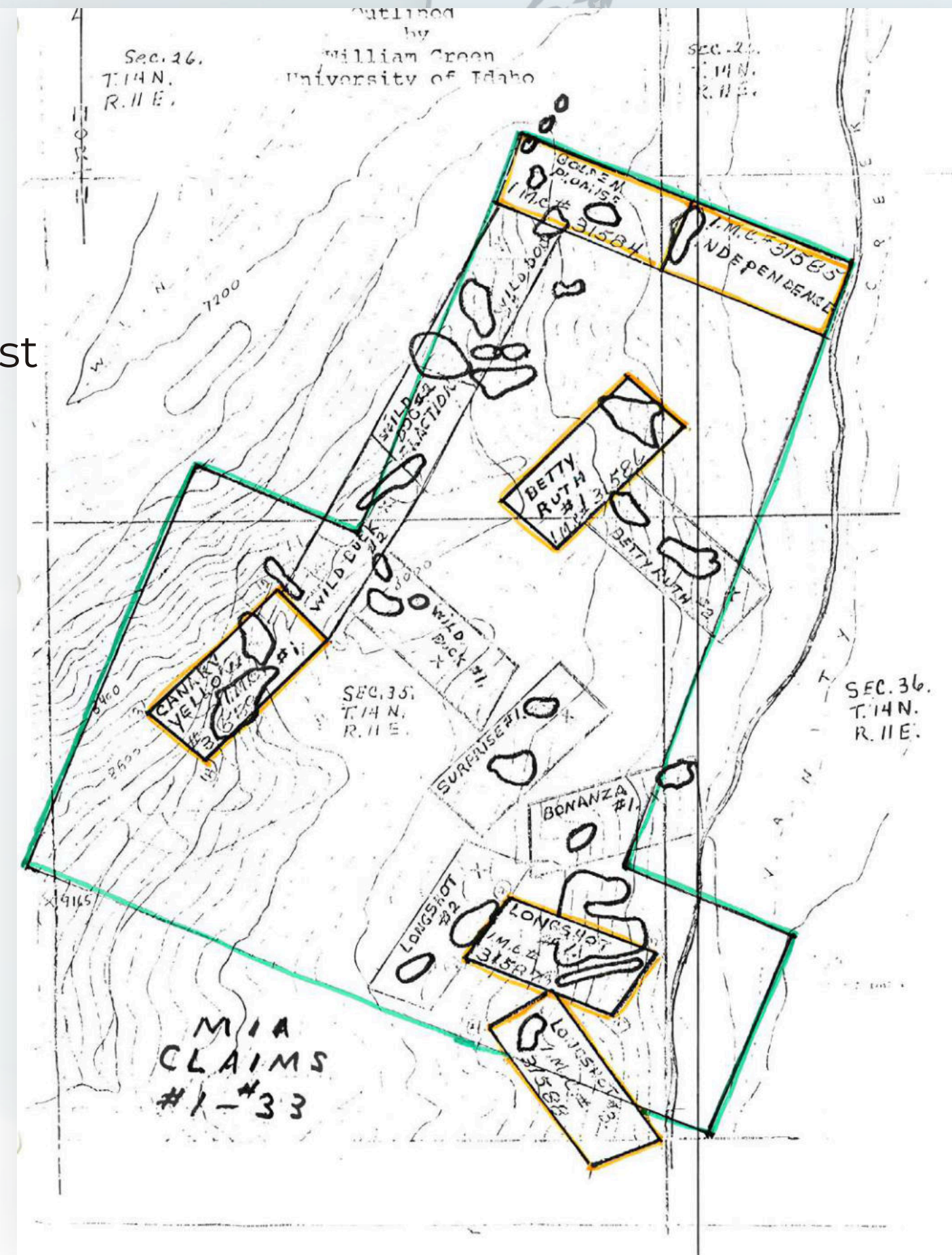

IDAHO

# PORTFOLIO OVERVIEW - Five Historical Mining Projects

## 03 Robinson Dike - Idaho, USA

- Historic mine with production dating back to 1935–36, including a 50-ton/day mill and cyanide leach tanks.
- Historical recovery rates of 95%, with 66.8 oz gold and 16 oz silver recovered from 2,839 tons.
- Drill-indicated near-surface gold reserve with heap leach potential.
- Historical resource: 940,000 tonnes @ 0.041 oz/ton gold.
- Historical resource (Non 43-101 Compliant) resource estimated at:
  - \*for exploration guidance only
  - 153,000 tons @ 0.068 oz/ton gold and 0.14 oz/ton silver (0.035 cutoff).
  - 191,000 tons @ 0.06 oz/ton gold and 0.14 oz/ton silver (0.025 cutoff).

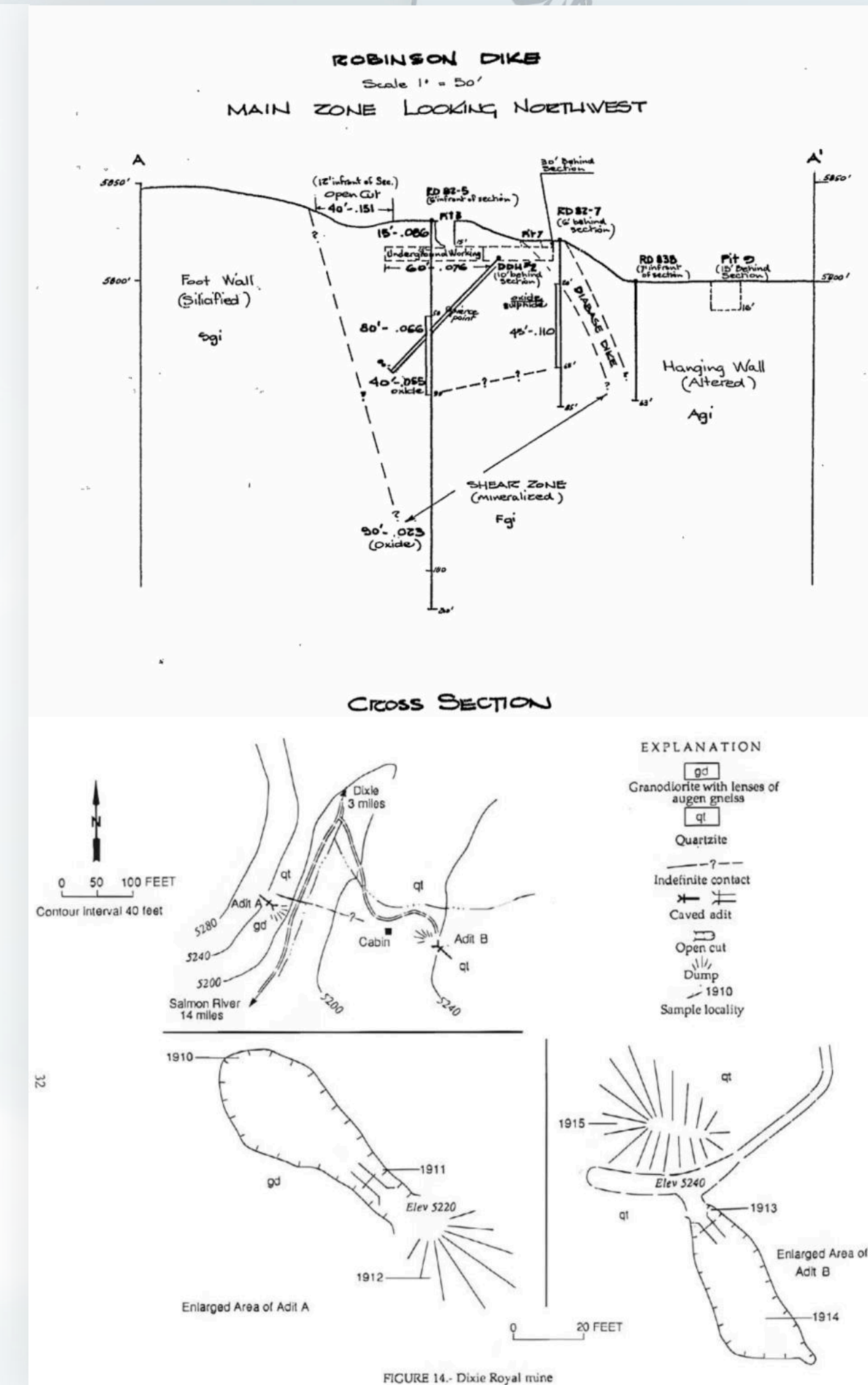

## PORTFOLIO OVERVIEW - Five Historical Mining Projects

### 04 Golden Dome Project - California, USA

- Explored extensively by Hecla, Amselco, and Tenneco Minerals in the 1980s–90s
- Defined historical resource in a high-sulfidation epithermal gold system.
- Tenneco planned an open-pit heap leach operation targeting 30,000–40,000 oz/year production.
- Project sold by Hecla for \$2 million, highlighting its recognized value.

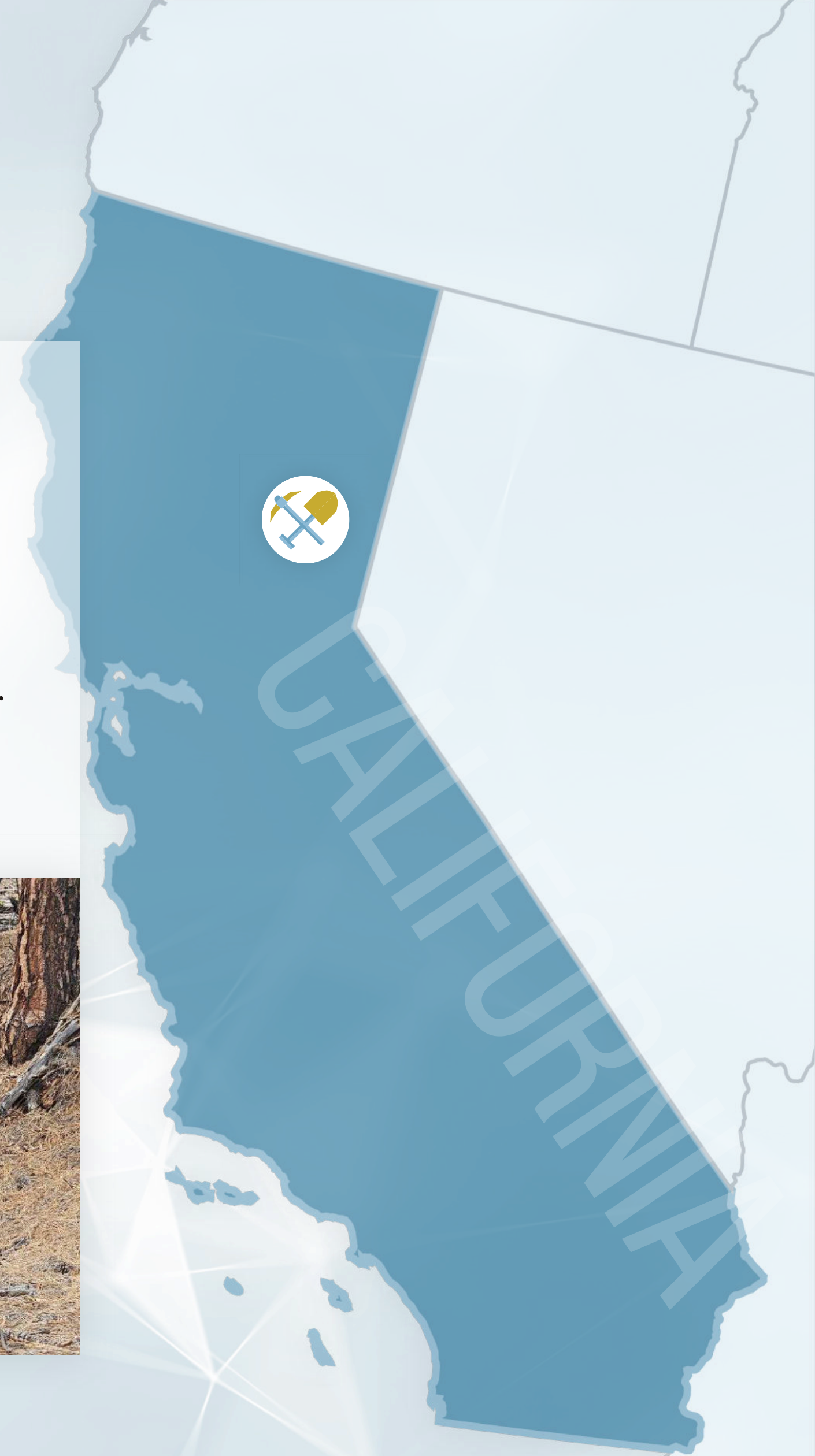

# PORTFOLIO OVERVIEW - Five Historical Mining Projects

## 05 Letain Nickel Project - British Columbia, Canada

- Covers 713.8 ha of ultramafic terrain with confirmed awaruite (Ni-Fe alloy) mineralization.
- Historical sampling shows 556–1,964 ppm Ni, averaging 1,250 ppm across a 1,100m trend.
- Davis tube tests show 17.2% magnetic mineral content, with QEMSCAN confirming nickel-bearing minerals.
- Accessible via Dease Lake, with Phase 1 mapping and Phase 2 drilling budgeted at \$445,000 CAD.
- Option agreement structured with staged payments and NSR buyback flexibility.

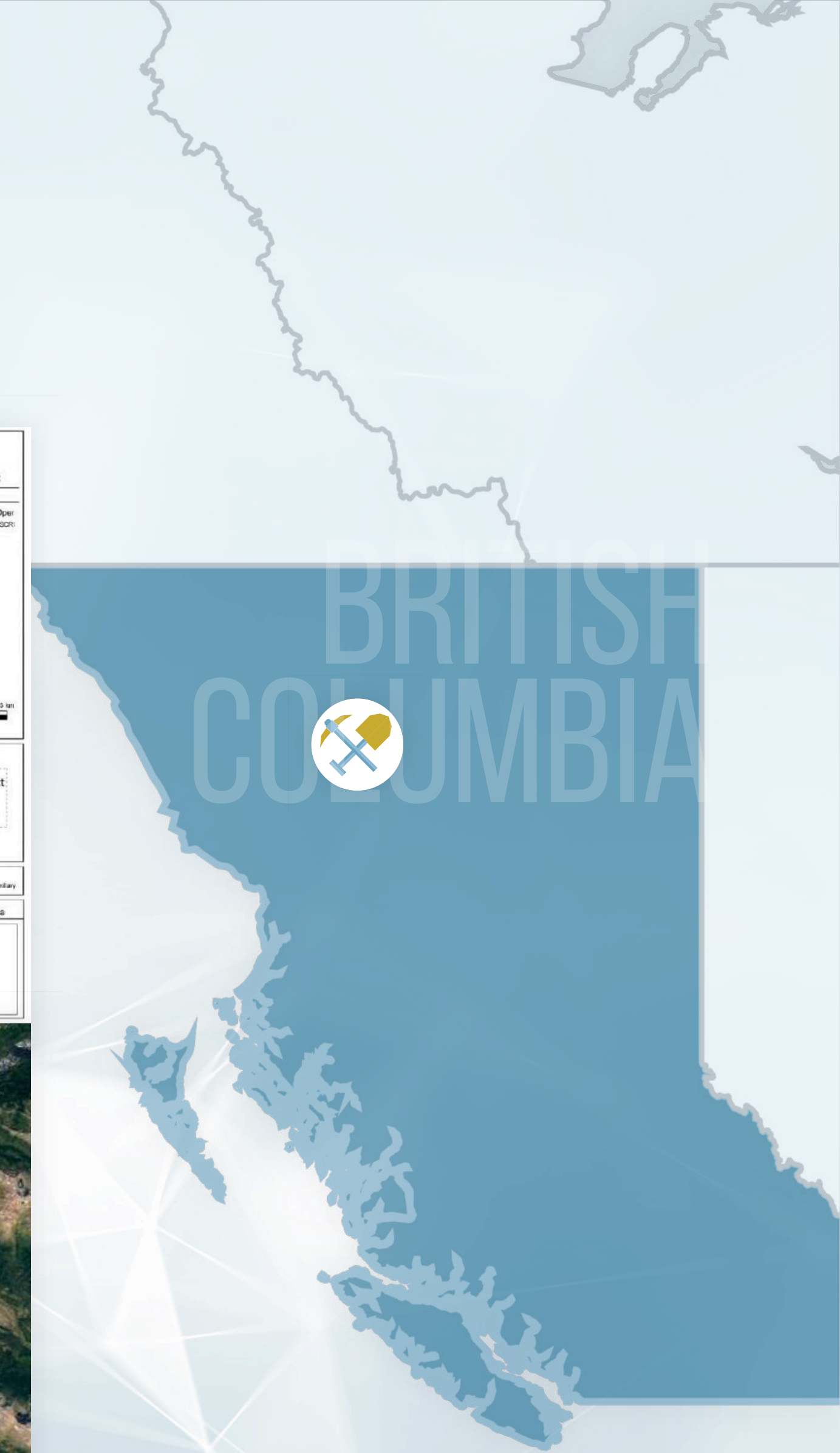
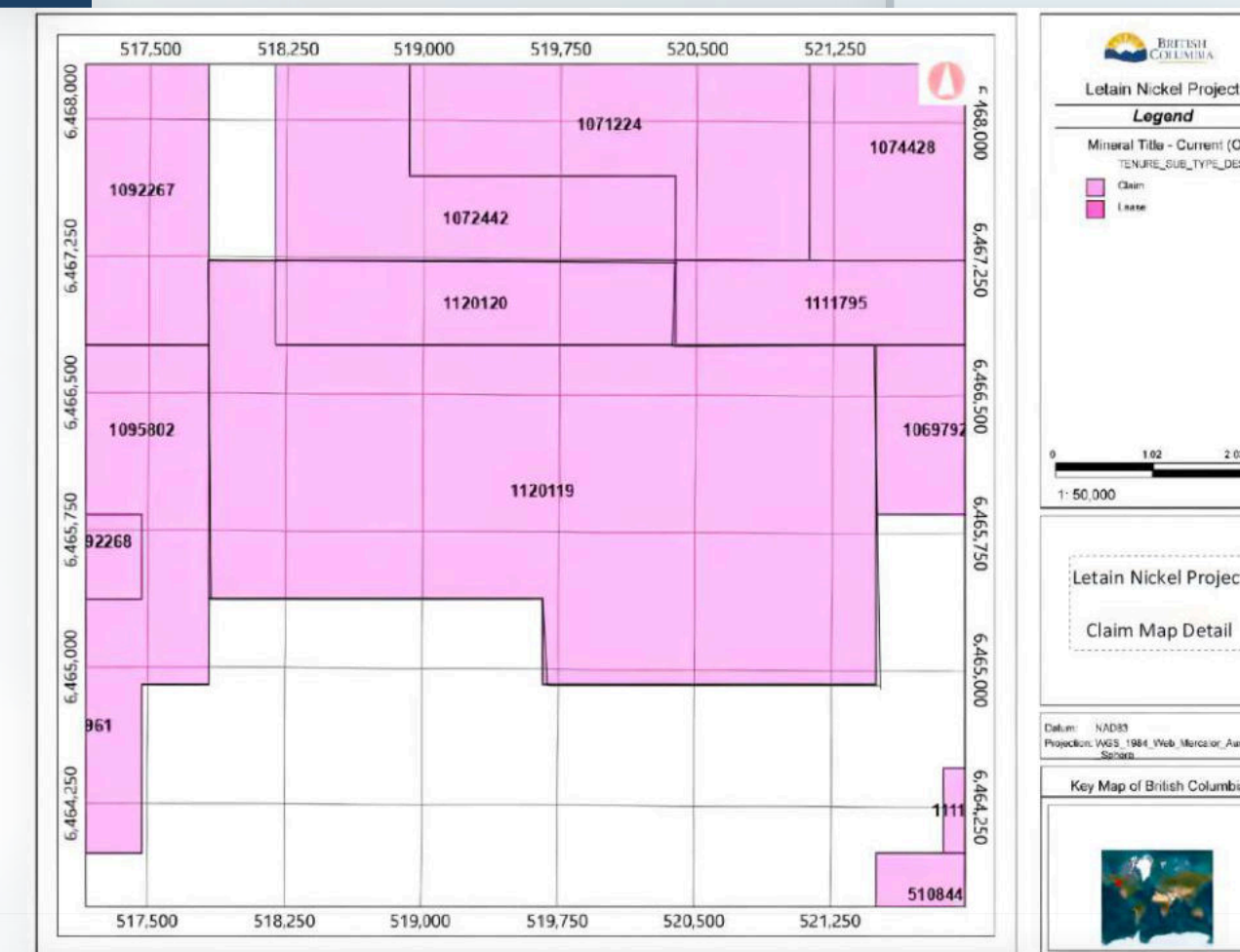

## Key Portfolio Features

- Combination of past production, feasibility-level work, and extensive historical datasets (sampling, drilling, metallurgical studies across multiple projects).
- Multi-metal exposure:
  - Precious metals: Gold & Silver – stability, safe-haven value, and industrial demand.
  - Strategic metals: Tungsten & Beryllium – defense, aerospace, and advanced manufacturing.
  - Battery metals: Nickel – clean energy transition and EV relevance.
- Geographic diversification across top-tier jurisdictions:
  - Idaho, Nevada, California (U.S.)
  - British Columbia (Canada)
- Clear re-rating potential:  
Historical data provides a foundation for modern validation programs using advanced exploration and metallurgical techniques.
- Balanced portfolio positioning:  
Exposure to metals that support financial stability, industrial strength, defense applications, and electrification, ensuring relevance across both traditional and emerging markets.

# » 2026 FLAGSHIP FOCUS

Vault Strategic Mining Corp. will prioritize one lead project in 2026 based on three key criteria:



## TECHNICAL READINESS

- Project must demonstrate clear geological understanding and metallurgical viability
- Historical feasibility work and validated recovery methods preferred
- Infrastructure access and permitting pathway considered



## QUALITY & SCALE OF HISTORICAL DATA

- Depth of sampling, drilling, and production records
- Presence of feasibility-level studies or government reports
- Proven mineralization with potential for compliant resource delineation



## NEAR-TERM EXECUTION & NEWS FLOW POTENTIAL

- Ability to launch low-cost validation programs (e.g. confirmatory drilling, geophysics)
- Clear milestones for technical updates, resource modeling, and permitting
- Strong potential for market re-rating and investor engagement

# DISCIPLINED OPTION ECONOMICS

Vault's acquisition model is designed to maximize asset control while minimizing capital exposure and shareholder dilution.

◆ Low Staged Cash Payments

- Structured over multiple years to preserve working capital
- Aligns payment milestones with technical progress and market conditions

◆ NSR Royalties with Buy-Down Options

- Net Smelter Return (NSR) royalties provide vendor upside while preserving project economics
- Built-in buy-down mechanisms allow Vault to reduce long-term royalty burden

◆ Independent Option Decisions

- Each project evaluated on its own merits
- Flexibility to advance, defer, or exit based on evolving data and strategy

◆ No Equity Dilution

- Acquisitions funded without issuing shares
- Preserves capital structure and protects shareholder value

This positions Vault as a disciplined acquirer focused on capital efficiency, strategic flexibility, and shareholder alignment.

# » CREDIBILITY AND DISCLOSURE

Vault Strategic Mining Corp. is committed to transparency and responsible communication of its portfolio.

## ◆ Historical Data Limitations

- All referenced exploration and production data are historical in nature
- Information is not NI 43-101 compliant and has not been independently verified

## ◆ No Current Resources or Reserves

- The Company is not declaring any mineral resources or reserves at this time
- Historical figures are presented for context only, not as compliant estimates

## ◆ Purpose of Historical Work

- Historical datasets are used solely for targeting, interpretation, and planning
- Provides geological guidance for modern exploration programs
- Supports identification of priority areas for technical validation

“Vault emphasizes transparency and disciplined disclosure, aligning with regulatory standards while using historical data strictly as a foundation for modern exploration.”

# 2026 ROADMAP AND CATALYSTS



**Q1 2026**  
Data Compilation  
& Prioritization

- ◆ Consolidate historical datasets across Idaho, Nevada, and California
- ◆ Rank assets by technical readiness, scale of data, and near-term potential



**Q2 2026**  
Field Verification &  
Technical Review

- ◆ On-site sampling, mapping, and geophysical checks
- ◆ Independent technical review to validate historical work and refine targets

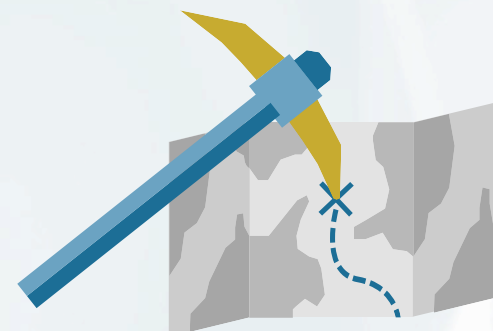

**Q3 2026**  
Drill Target  
Confirmation

- ◆ Evaluate field results and determine priority zones for drilling
- ◆ Announce flagship project priority drill zones



**Q3 2026**  
Technical Update &  
Next-Stage Planning

- ◆ Deliver technical update to market with validated results
- ◆ Outline next-stage exploration and development strategy for 2027

Vault's disciplined roadmap ensures steady technical progress and clear investor milestones throughout 2026.

## » CAPITAL DISCIPLINE

Vault is careful with its funds and puts shareholders first. Here's how:

- ◆ Option-Based Growth

- Vault structures acquisitions through staged option payments, limiting upfront capital exposure while retaining the flexibility to walk away if a project does not meet expectations.

- ◆ Upside Per Share Focus

- Vault avoids issuing new shares for acquisitions, ensuring existing shareholders are not diluted and preserving full upside per share.

- ◆ Justified Capital Deployment

- Vault deploys capital only when technical milestones are achieved, directing funds toward validated, high-potential opportunities.

**Smart Options - No Dilution - Targeted Spending**

Vault grows with discipline and investor alignment.

# » Upcoming Momentum

Vault offers investors a timely entry point with disciplined growth and near-term catalysts.

## ◆ Exclusive Asset Options

▸ Vault has secured exclusive option rights to advanced historical U.S. mining assets, providing strategic control without heavy upfront commitments.

## ◆ Low, Staged Entry Costs

▸ Entry costs are structured to be low and staged, effectively limiting downside risk while preserving upside potential.

## ◆ Top-Tier Jurisdictions

▸ All assets are located in top-tier jurisdictions with established infrastructure, reducing development risk and accelerating timelines.

## ◆ Transition to Execution

▸ The company is transitioning from acquisition into execution, marking a clear inflection point toward value creation.

## ◆ Near-Term Catalysts

▸ Upcoming technical milestones present near-term catalysts with the potential to drive a market re-rating.



From **acquisition** to **execution** 2026 marks Vault's inflection point.

Vault Strategic Mining Corp.  
provides investors with early-stage leverage  
to high-quality N. American mining assets  
through a disciplined, option-based strategy  
designed to maximize upside while  
controlling risk.

## REFERENCES

### Wheeler Tungsten Project

[Mount Wheeler Mine, Mount Washington, Mount Washington Mining District \(Lincoln Mining District\), Snake Range, White Pine County, Nevada, USA](#)

[Mount Wheeler Mine, Mount Washington, Mount Washington Mining District \(Lincoln Mining District\), Snake Range, White Pine County, Nevada, USA \(Page 7\)](#)

[download.php \(Page 5\)](#)

[mla\\_56-83.pdf \(Page 29\)](#)

### Mia Silver Project

[https://www.idahogeology.org/Uploads/Data/MineDocs/CH0234\\_002.pdf](https://www.idahogeology.org/Uploads/Data/MineDocs/CH0234_002.pdf) (Page 1)

[https://www.idahogeology.org/Uploads/Data/USBM-Publications/MLA\\_87-83.pdf](https://www.idahogeology.org/Uploads/Data/USBM-Publications/MLA_87-83.pdf) (Page 24-25)

[https://www.idahogeology.org/Uploads/Data/MineDocs/CH0234\\_002.pdf](https://www.idahogeology.org/Uploads/Data/MineDocs/CH0234_002.pdf) (Page 1)

[https://www.idahogeology.org/Uploads/Data/MineDocs/CH0234\\_003.pdf](https://www.idahogeology.org/Uploads/Data/MineDocs/CH0234_003.pdf) (Page 7)

[https://www.idahogeology.org/Uploads/Data/MineDocs/CH0234\\_003.pdf](https://www.idahogeology.org/Uploads/Data/MineDocs/CH0234_003.pdf) (Page 7 and 8)

[https://www.idahogeology.org/Uploads/Data/MineDocs/CH0234\\_003.pdf](https://www.idahogeology.org/Uploads/Data/MineDocs/CH0234_003.pdf) (Page 8 and 9)

[https://www.idahogeology.org/Uploads/Data/MineDocs/CH0234\\_003.pdf](https://www.idahogeology.org/Uploads/Data/MineDocs/CH0234_003.pdf) (Page 9)

[https://www.idahogeology.org/Uploads/Data/MineDocs/CH0234\\_003.pdf](https://www.idahogeology.org/Uploads/Data/MineDocs/CH0234_003.pdf) (Page 9-10) [https://www.idahogeology.org/Uploads/Data/MineDocs/CH0234\\_001.pdf](https://www.idahogeology.org/Uploads/Data/MineDocs/CH0234_001.pdf)

[https://www.idahogeology.org/Uploads/Data/MineDocs/CH0234\\_001.pdf](https://www.idahogeology.org/Uploads/Data/MineDocs/CH0234_001.pdf)

### Robinson Dike & Gold Leaf

[report \(Page 31-34\) See Report](#)

[\(Page 34\)](#)

### Golden Dome

[file regdev86](#) - (Page 17) MINERALS MINING AND ENERGY IN IDAHO, 1986 - Idaho Geological

[Tenneco opens Fondaway mine - The Northern Miner](#) - February 5, 1990 [Golden-Dome.pdf](#) -

[Exploration of a High-Sulfidation Epithermal Deposit within the Antelope](#)

[Valley Volcanic Center, Sierra County California](#) by Sommer M. Cassidy & Hanna M. Aird (7 Pages)

### Letain Nickel Project

[43-101OldNickTechnical.pdf](#)



# VAULT

STRATEGIC MINING CORP.

---

TSXV:KNOX | OTC:KNXFF | FSE:M850

[www.vaultstrategic.com](http://www.vaultstrategic.com)